



### CRS Data

#### LOCATION

<b>Property Address</b>	25655 Whitaker Hollow Rd Abingdon, VA 24211-5286
<b>Subdivision</b>	Dentons Valley Acr .5
<b>County</b>	Washington County, VA

#### PROPERTY SUMMARY

<b>Property Type</b>	Agricultural
<b>Land Use</b>	Agr/Unddev 20-99 Acr
<b>Improvement Type</b>	Dwelling
<b>Square Feet</b>	900

#### GENERAL PARCEL INFORMATION

<b>Parcel ID/Tax ID</b>	147 A 27	011778
<b>Alternate Parcel ID</b>	14464	
<b>Account Number</b>	11778	
<b>District/Ward</b>	MA	
<b>2010 Census Trct/Blk</b>	110/1	
<b>Assessor Roll Year</b>	2015	

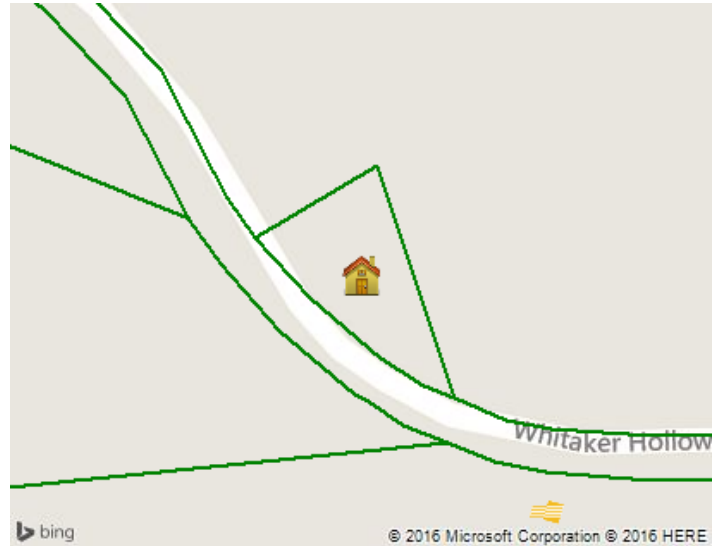

#### CURRENT OWNER

<b>Name</b>	Baumgardner Slep (L E ) C/O Janice Nunnally
<b>Mailing Address</b>	22410 Shippings Rd Mc Kenney, VA 23872-2104

#### SALES HISTORY THROUGH 11/02/2016

Date	Amount	Buyer/Owners	Buyer/Owners 2	Instrument	No. Parcels	Book/Page Or Document#
6/10/1999		Baumgardner Slep (L E )			2	1050/818

#### TAX ASSESSMENT

Appraisal	Amount	Assessment	Amount
<b>Appraisal Year</b>	2016	<b>Assessment Year</b>	2016
<b>Appraised Land</b>	\$20,000	<b>Assessed Land</b>	\$20,000
<b>Appraised Improvements</b>	\$25,600	<b>Assessed Improvements</b>	\$25,600
<b>Total Tax Appraisal</b>	\$45,600	<b>Total Assessment</b>	\$45,600
		<b>Exempt Amount</b>	
		<b>Exempt Reason</b>	

#### TAXES

Tax Year	City Taxes	County Taxes	Total Taxes
2016		\$287.28	\$287.28
2015		\$287.28	\$287.28
2013		\$287.00	\$287.00

#### MORTGAGE HISTORY

Date	Loan Amount	Borrower	Lender	Book/Page or Document#
12/22/2008	3,580	Baumgardner Slep Betty R (L.E.)	People	080008397

#### PROPERTY CHARACTERISTICS: BUILDING

## Building # 1

<b>Type</b>	Dwelling	<b>Condition</b>	Average	<b>Units</b>	
<b>Year Built</b>	1940	<b>Effective Year</b>		<b>Stories</b>	1
<b>BRs</b>	3	<b>Baths</b>	1 F H	<b>Rooms</b>	5
<b>Total Sq. Ft.</b>	900				
<b>Building Square Feet (Living Space)</b>			<b>Building Square Feet (Other)</b>		
			Base Section 900		
			Porch 140		

## - CONSTRUCTION

<b>Quality</b>		<b>Roof Framing</b>	Gable
<b>Shape</b>		<b>Roof Cover Deck</b>	Metal
<b>Partitions</b>		<b>Cabinet Millwork</b>	
<b>Common Wall</b>		<b>Floor Finish</b>	Wood Flooring
<b>Foundation</b>	Cinderblock	<b>Interior Finish</b>	Paneled
<b>Floor System</b>		<b>Air Conditioning</b>	Central Air Conditioning
<b>Exterior Wall</b>	Frame	<b>Heat Type</b>	Heat Pump
<b>Structural Framing</b>		<b>Bathroom Tile</b>	
<b>Fireplace</b>		<b>Plumbing Fixtures</b>	

## - OTHER

<b>Occupancy</b>	<b>Building Data Source</b>
------------------	-----------------------------

## PROPERTY CHARACTERISTICS: EXTRA FEATURES

Feature	Size or Description	Year Built	Condition
Stge Bldg X3@100.00			AVERAGE

## PROPERTY CHARACTERISTICS: LOT

<b>Land Use</b>	Agr/Unddev 20-99 Acr	<b>Lot Dimensions</b>	
<b>Block/Lot</b>		<b>Lot Square Feet</b>	21,780
<b>Latitude/Longitude</b>	36.642730°/-81.910059°	<b>Acreage</b>	0.5

## PROPERTY CHARACTERISTICS: UTILITIES/AREA

<b>Gas Source</b>	No	<b>Road Type</b>	Gravel
<b>Electric Source</b>	Electric	<b>Topography</b>	Rolling/Sloping
<b>Water Source</b>	Well	<b>District Trend</b>	
<b>Sewer Source</b>	Septic	<b>Special School District 1</b>	
<b>Zoning Code</b>		<b>Special School District 2</b>	
<b>Owner Type</b>			

## LEGAL DESCRIPTION

<b>Subdivision</b>	Dentons Valley Acr .5	<b>Plat Book/Page</b>	
<b>Block/Lot</b>		<b>District/Ward</b>	MA
<b>Description</b>	Dentons Valley Acr .5		

## FLOOD ZONE INFORMATION

Zone Code	Flood Risk	BFE	Description	FIRM Panel ID	FIRM Panel Eff. Date
X	Minimal		Area of minimal flood hazard, usually depicted on FIRMs as above the 500-year flood level.	51191C0295C	09/29/2010